



www.gotowti.com

An ISO 9001:2000 Certified Company



Wireless Technology, Inc.

**AV-I
Ambervision I
Interface Panel**

Installation Manual

Table of Contents

IMPORTANT	PAGE 3
PRODUCT WARRANTY INFORMATION	PAGE 4
REPAIR INFORMATION	PAGE 5
SAFEGUARDS & TOOLS	PAGE 6
AMBERVISION I	PAGE 7
INTERFACE PANEL	PAGE 9
TECHNICAL SPECIFICATIONS	PAGE 11

IMPORTANT

READ THIS MANUAL

Every effort has been made to insure that this WTI system is of the highest quality. This product has been carefully inspected to comply with rigid quality standards before shipment to you. In consideration of your investment and the desire to obtain full performance capability engineered into your new WTI product, we recommend that you read this manual before attempting to operate your system.

FOR MORE ASSISTANCE OR MORE INFORMATION:

Wireless Technology, Inc. (WTI)
2064 Eastman Avenue, Suite 113
Ventura, CA 93003-7787

TEL 805/339-9696
FAX 805/339-0932

EMAIL: sales@wirelesstech.com
INTERNET: <http://www.gotowti.com> or <http://www.wirelesstech.com>

The software / firmware furnished with the equipment is confidential to and is copyrighted by *Wireless Technology, Inc.* (WTI) It is not to be copied or disclosed in any manner without the consent of *Wireless Technology, Inc.* (WTI). The software/firmware is furnished to the purchaser under a license for use on a single system.

Information furnished by *Wireless Technology, Inc.* (WTI) is believed to be accurate and reliable. However, no responsibility is assumed by *Wireless Technology, Inc.* (WTI) for its use or for any infringements of other rights of third parties, which may result from its use. No license is granted by implications or otherwise under any patent or patent rights of *Wireless Technology, Inc.* (WTI)

©2009 Wireless Technology, Inc. (WTI)
All rights reserved.

PRODUCT WARRANTY INFORMATION

PRODUCT WARRANTY

We appreciate your purchase of *Wireless Technology, Inc.* (WTI) security products. We take pride in the quality of our products and have manufactured each new WTI product to exacting quality standards. In normal use, it will provide you with years of satisfactory performance. However, should you experience difficulty; you are protected under the provisions of this warranty.

WTI warrants to the original user a product that is free of defects in materials and workmanship in normal use. WTI warrants to the original user that WTI's products will be free of defects in materials and workmanship in normal use for a period of 12 months from the date of sale. WTI's obligation under this warranty shall be limited to the repair, including all necessary parts and the cost of labor connected therewith, or at our option, the replacement of any product that shows evidence of a manufacturing defect within the warranty period.

This warranty is extended to all WTI products purchased and used within the United States of America and is valid only when service is rendered by the authorized *Wireless Technology, Inc.* (WTI) Warranty Station.

This warranty shall not apply to appearance or accessory items including, but not limited to, knobs, connectors, cabinets and connecting cables. This warranty shall not, in addition, apply to repairs or replacements necessitated by any cause beyond the control of WTI including, but not limited to, acts of nature, improper installation, misuse, lack of proper maintenance, accident, voltage fluctuations, unauthorized repairs or modifications.

This warranty becomes void in the event serial numbers are altered, defaced or removed, or an attempt is made to field service or alter performance of any products.

WTI reserves the right to make changes in design, or to make additions to, or improvements upon, products without incurring any obligation to install the same on products previously manufactured.

The foregoing is in lieu of all other warranties expressed or implied and WTI neither assumes nor authorizes any person to assume for it any other obligation or liability in connection with the sale of our products. In no event shall WTI or its Authorized Dealers be liable for special or consequential damage arising from the use of this product, or any delay in the performance of this warranty due to causes beyond its control.

REPAIR INFORMATION

REPAIR AUTHORIZATION

Please contact *Wireless Technology, Inc.* (WTI), to obtain a repair authorization number (RA) and provide the following information:

- 1.) Product Model & Serial Numbers
- 2.) Date of shipment, purchase order number, sales order number or WTI invoice number.
- 3.) Details of the defect or malfunction. If there is a dispute regarding the warranty or product, which does not fall under the warranty conditions stated within the description of the written warranty, please include a written explanation with the product when returned.

SHIP FREIGHT PRE-PAID TO:

Wireless Technology, Inc. (WTI)
2064 Eastman Avenue, Suite 113
Ventura, CA 93003-7787
TEL 805/339-9696
FAX 805/339-0932

RETURNS

No unauthorized returns will be accepted. All returns must have an authorized (RA) number issued by the factory (CA number if returned for credit and RA number if returned for repair). Products returned for repair or credit will be rejected if no authorization number has been issued or freight has not been pre-paid. All merchandise returned for credit will be subject to a 20% restocking and refurbishing charge.

SAFEGUARDS & TOOLS

IMPORTANT SAFEGUARDS

- 1.) Read Instructions. It is important to read all safety and operating instructions before installing or using this equipment.
- 2.) Retain Instructions. Retain this manual and any supplements for future reference.
- 3.) Follow Instructions. Follow all instructions herein for use of this equipment.

Do not attempt to open the sealed camera assembly. There are no user-serviceable parts inside. Refer servicing to the *Wireless Technology, Inc. (WTI)* factory service center only.

- 4.) Heed warnings. Adhere to all warnings on the equipment, and in this manual.
- 5.) To reduce the risk of electric shock or equipment damage, work on the unit only when the power is shut off and is unplugged from its power source to prevent accidental activation. Also take precautions to avoid contact between the equipment and other electrical wires or power sources that may be present at the installation site.

RECOMMENDED TOOLS AND ACCESSORIES FOR PROPER INSTALLATION:

- 1.) Tie-wraps to secure cable runs
- 2.) #1 Phillips screwdriver
- 3.) #3 and 1/8" slot screwdrivers
- 4.) Cordless power drill
- 5.) 1/2" open end wrench or 1/2" socket wrench
- 6.) Silicone caulking compound
- 7.) Self-sealing connector tape - Used to weatherproof all outdoor cable connections
- 8.) Appropriate conduit if boxes are mounted outdoors.
- 9.) Hand held radios

Wireless Technology, Inc. (WTI) recommends the use of RG59/U such as Belden 8241 or equivalent 75Ω coaxial cable with 22-gauge solid copper center conductor and foam polyethylene dielectric. Either RG6/U or RG11/U would make an excellent substitute.

Long coaxial cable runs cause signal degradation and/ or "SYNC" discrepancies. Limit RG59/U cable lengths to 500 feet.

Do not use screw on type BNC connectors. They are not suited for reliable installations.

AMBERVISION I

I. Basic Information

a. General description

- i. The Ambervision-I operates on 24VAC. Typical installations include an interface panel which contains all breakout points for wiring the Ambervision-I cables as well as the field wiring for 120VAC or 220VAC power, and video.
- ii. Ambervision-I is an adjustable zoom camera. Zoom changes can be made over the coax with a handheld controller (HHC-7000).
- iii. Ambervision-I has a built-in wall mount with an optional pole mount adapter.

b. Interface Panel (Optional)

- i. An interface panel is available for external installations that require 120VAC or 220VAC power.

c. Cable and Cabling

- i. The Ambervision-I is (by default) pre-wired with video and power cables. One terminated with BNC for video and one power cable.

II. Installation/Setup

a. Installation

- i. Mount Ambervision-I camera.
- ii. Mount interface panel (Option).
- iii. Install power cable or Wall Transformer.
 1. If using interface panel, run power cable from Ambervision-I to interface panel. Then, continue power cable from interface panel to power source.
- iv. Install video cable from Ambervision-I to desired video device.
 1. If using interface panel, run video cable from Ambervision-I to interface panel. Then, continue video cable from interface panel to video device (monitor, DVR, etc.)

AMBERVISION I

Ambervision I with pole mount adapter installed.

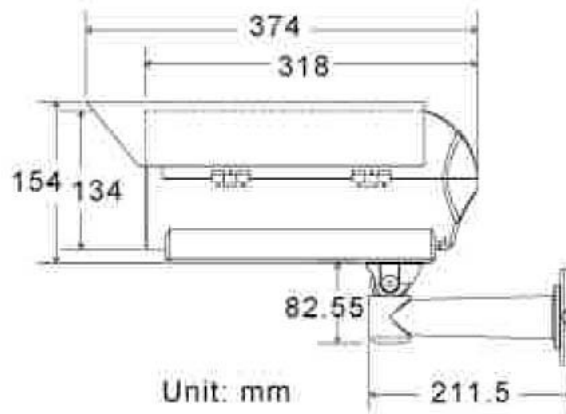

INTERFACE PANEL

Interface Panel with the door open.

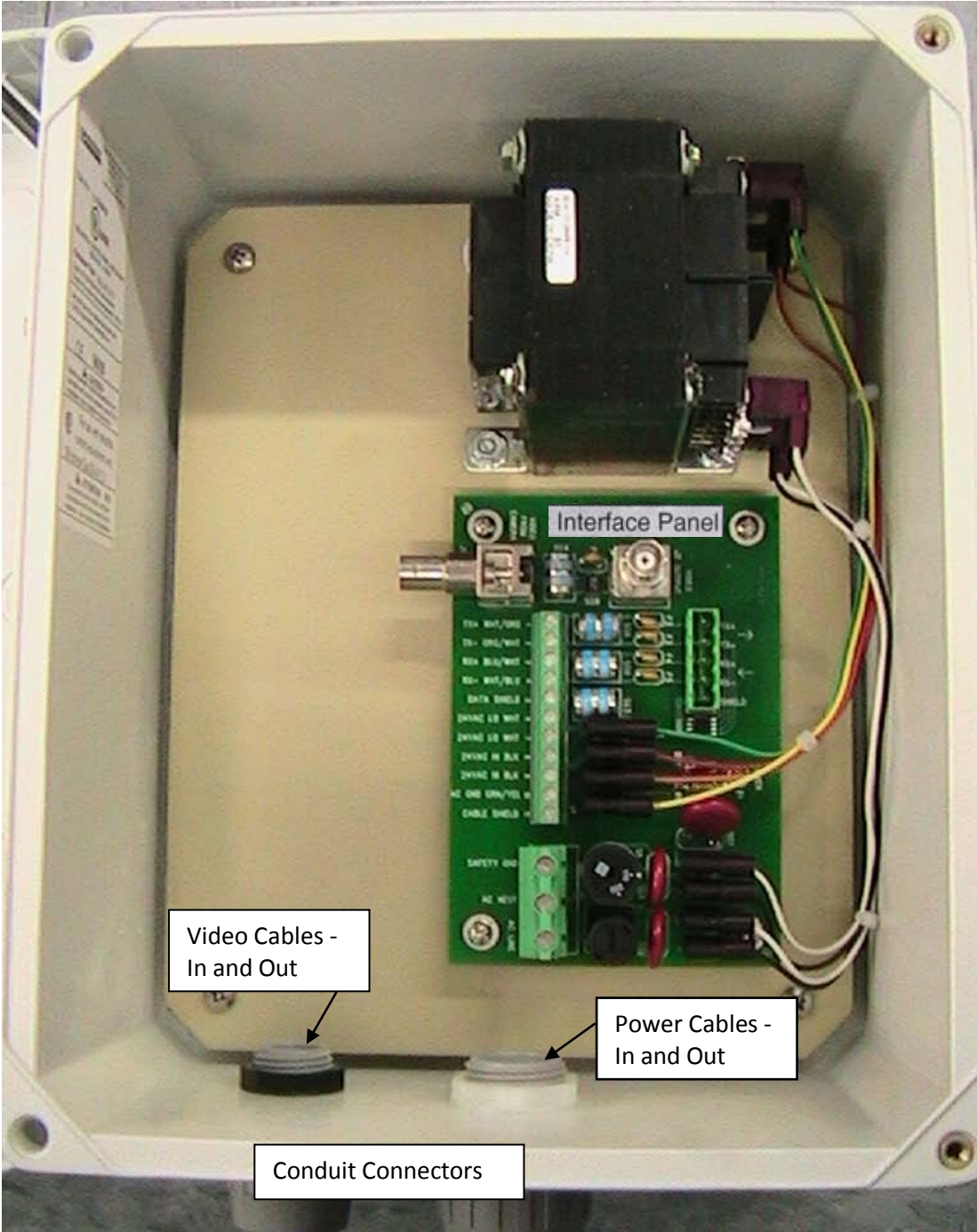

INTERFACE PANEL

Interface panel close-up; Wiring breakout area.

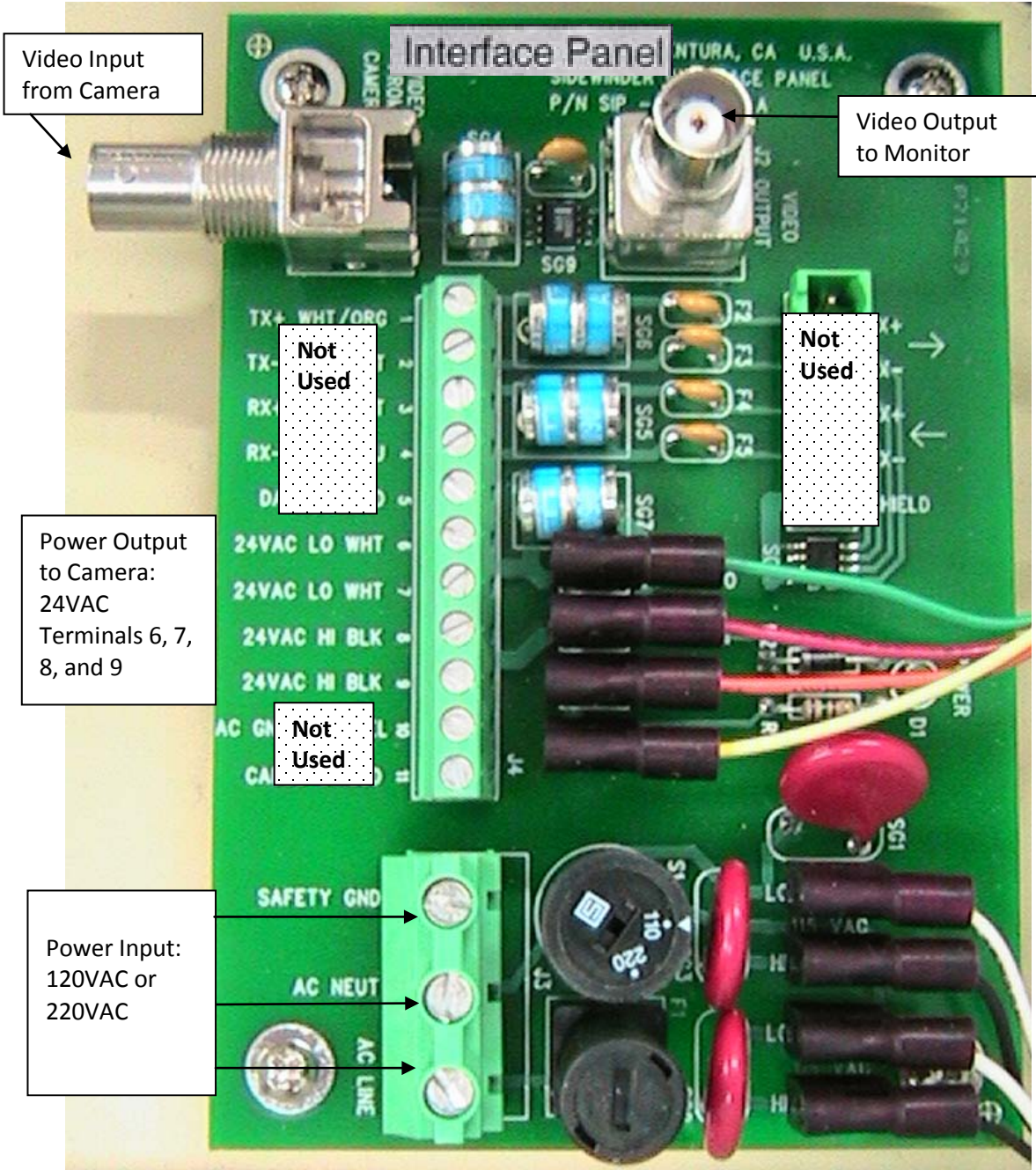

TECHNICAL SPECIFICATIONS

Ambervision I, I-LR, 940

Camera		Infrared Illuminator Housing	
Imager	¼" color progressive scan, interline transfer CCD	Radiant Distance	AVI: 100M maximum AVI-LR: 200M maximum AV940: 80M maximum
Resolution*	NTSC or PAL, 470 horizontal TV lines*	Wave Length	AVI & AVI-LR: 850nm AV940: 940nm
Effective Pixels*	NTSC @ 724 x 494*, PAL @ 724 x 582*	Window	110 heat resistant glass
Lens*	High durability 23X optical zoom*, F1.6 with 12X digital zoom*	Glass Thickness	3mm
Focal Length	3.6mm ~ 38mm*	LED On/Off	CDS auto control, adjustable control point
S/N Ratio	>52 dB	Heater Control	On: <15° C, Off: >25° C
Iris	Auto or manual override	IP Rating	IP66
Shutter	Auto or manual override	Communications / Physical Layer	
Focus	Auto or manual override	Format	RS-232 over coax using proprietary RF modem **
Sync	Internal / line lock	Data	488 baud
IR Cut Filter	Auto or manual (on/off)	Parameter Set	Optical zoom using HHC-7000 controller only – other camera functions using HHC-7000 and laptop computer with proprietary camera control software
Sensitivity*	3 Lux typical down to 0.01 Lux in IR mode*	Coax Length	500 feet if RG-59/U or RG-6/U
Electrical		Optional pole mount bracket available.	
Input Voltage	14 VAC to 27 VAC	*35X optical zoom option:	
Power Consumption	27W maximum with heater and LED illumination on	Resolution	520 horizontal TV lines
Environmental		Effective Pixels	NTSC @ 768 x 494, PAL @ 768, 582
NEMA TS-2		Lens	High durability 35X optical zoom, F1.4 with 10X digital zoom
Temperature	-29° F to +165° F (-34° C to +74° C)	Focal Length	3.4mm ~ 120mm
Humidity	0 to 95% relative humidity	Sensitivity	0.5 Lux typical down to 0.01 Lux in IR mode
Mechanical		 <p>**Requires optional WTI Hand-Held Controller HHC-7000; See the HHC-7000 spec sheet for more information.</p>	
Weight	9 lbs. (4 kgs.) ± 0.5 lbs.		
Dimensions	14.75" L x 6.1" H ± 0.5" (374mm L x 154 mm H)		



www.gotowti.com

An ISO 9001:2000 Certified Company

WTI (*Wireless Technology, Inc.*)
2064 Eastman Avenue, Suite 113
Ventura, CA 93003-7787
U.S.A.

tel 805/339-9696 • toll free 866/gotowti • fax 805/339-0932

www.gotowti.com • www.wirelesstech.com

MADE IN THE U.S.A.

Due to Wireless Technology, Inc. (WTI) continuing efforts to engineer the best product that is most responsive to our customer's needs, the above specifications are subject to change without notice.

email: sales@wirelesstech.com

Page 12 of 12
R0409